



## Submersible Dewatering Pump

Type DEMINY

Submersible electric drainage pumps for most demanding dewatering applications. Suitable for drainage applications of construction sites and small tunnels, used for the movement of moderately charged water containing abrasive materials, for irrigation systems, rainwater and ground-water.

### TECHNICAL DATA

- Max. immersion 5m (with 10m cable length)
- Max. temperature of the liquid (sewage water): 35°C
- Max. solids passage: 10mm
- Pump Speed: 2 Poles
- Insulation class F
- Protection degree IP68
- Voltage: - Single phase 1~230V±10%,  
- Three phase 3~400V±10%

### MATERIALS

- Pump body: AISI 304 (EN 1.4301)
- Impeller:
  - AISI304 (50DEMINY – 80DEMINY)
  - GJS400 with treatment (100DEMINY)
- Shaft: AISI 316 (EN 1.4401)
- Mechanical seal:
  - Impeller side: Silicon Carbide/Ceramic,
  - Motor side: Graphite/Ceramic



## PERFORMANCE CHART

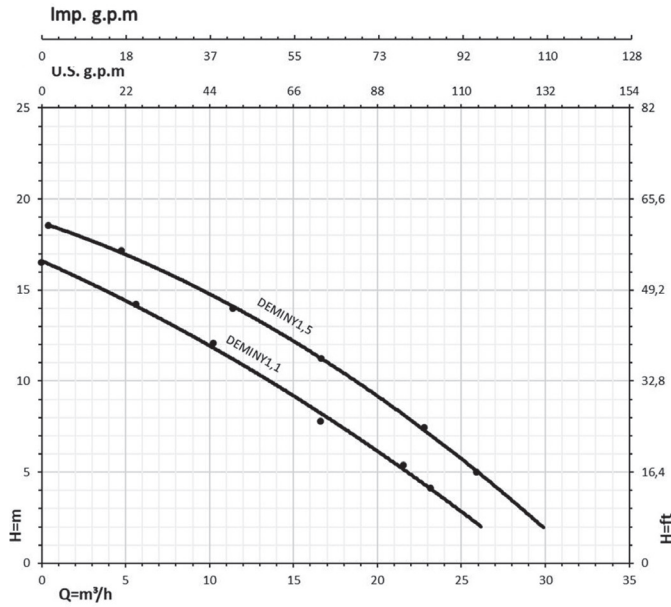

### 50DEMINY

Pump Type		Power kW	Q=Capacity							
Single phase	Three phase		[l/min]	0	83,33	166,7	250	333,3	416,7	500
			[m³/h]	0	5	10	15	20	25	30
H=Total manometric head in meters										
50DEMINY51,1M	50DEMINY51,1T	1.1		16,5	14,5	12,0	9,0	6,0	3,0	-
50DEMINY51,5M	50DEMINY51,5T	1.5		18,5	17,0	14,7	12,0	9,0	5,8	2,0

Rotation speed ≈ 2800 min<sup>-1</sup>  
Test standard: ISO 9906 – Annex A

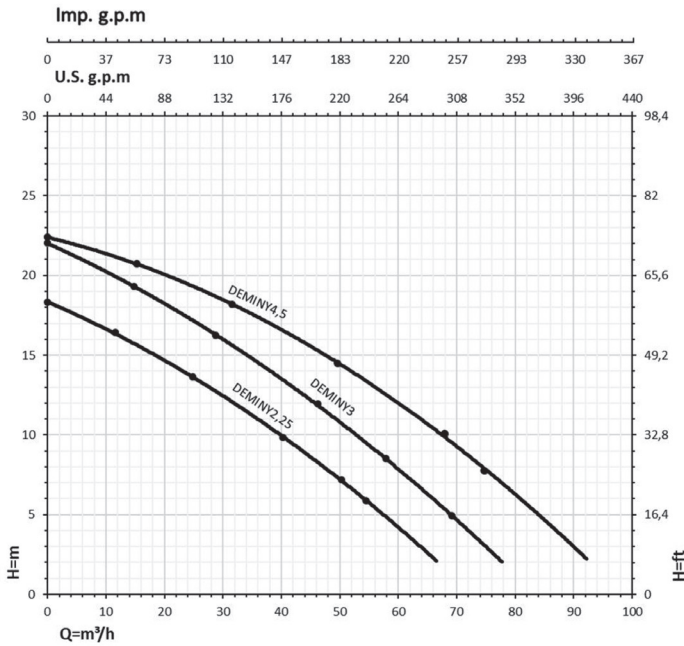

### 80DEMINY

Pump Type		Power kW	Q=Capacity								
Single phase	Three phase		[l/min]	0	250	500	750	1000	1250	1300	1533
			[m³/h]	0	15	30	45	60	75	78	92
H=Total manometric head in meters											
80DEMINY52,25M	80DEMINY52,25T	2.25		18,5	15,8	12,5	8,5	4,0	-	-	-
	80DEMINY53T	3.0		22,0	19,0	16,0	12,0	8,0	3,0	2,0	-
	80DEMINY54,5T	4.5		23,0	21,0	18,5	15,5	12,0	8,0	7,0	2,0

Rotation speed ≈ 2800 min<sup>-1</sup>  
Test standard: ISO 9906 – Annex A

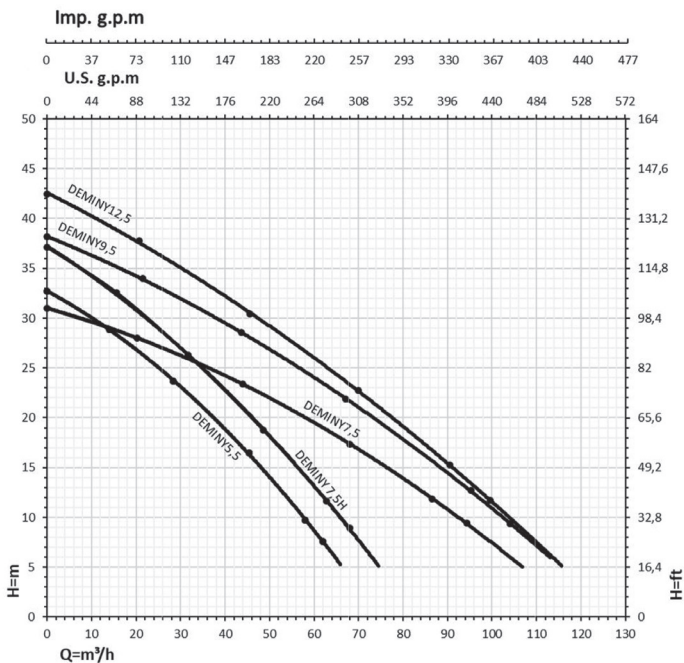

### 100DEMINY

Three phase	Power kW	Q=Capacity										
		[l/min]	0	167	500	833	1167	1333	1500	1833	1917	2033
		[m³/h]	0	10	30	50	70	80	90	110	115	122
H=Total manometric head in meters												
100DEMINY55,5T	5.5		33,0	30,0	23,0	14,0	2,0	-	-	-	-	-
100DEMINY57,5HT	7.5		37,0	34,0	27,0	18,0	7,5	2,0	-	-	-	-
100DEMINY57,5T	7.5		31,0	29,5	26,0	22,0	17,0	14,0	11,0	4,0	2,0	-
100DEMINY59,5T	9.5		38,0	36,0	32,0	27,0	21,0	18,0	14,5	7,0	5,0	-
100DEMINY512,5T	12.5		42,5	40,0	35,0	29,0	22,5	19,0	15,5	7,5	5,5	2,0

Rotation speed ≈ 2800 min<sup>-1</sup>  
Test standard: ISO 9906 – Annex A

## SPECIFICATIONS

PUMP		
Liquid Handled	Type of liquid	Water with mud contents
	Max temperature [°C]	35
	Max solids size [mm]	Ø10
Maximum immersion [m]		17
Construction	Impeller	Open
	Shaft seal type	Double mechanical seal wholly enclosed in a oil chamber
Pipe Connection	Suction [mm]	10 Open
Material	Casing	AISI 304
	Impeller	AISI304 (50DEMINY – 80DEMINY) GJS400 with treatment (100DEMINY)
	Casing cover	AISI 304
	Shaft seal	Pump side : SiC/SiC/NBR Motor side : Graphite/ SiC /NBR
	Seal cover	AISI 304
	Shaft	AISI 316 (wet extension)
	Lubricating liquid	White mineral oil: Vabriol atoxoil
Applicable standard of test	ISO 9906 - Annex A	

MOTOR		
Type	Submersible oil bath motor	
	Single Phase	Three Phase
No. of Poles	2	
Rotation speed [min <sup>-1</sup> ]	≈ 2800	
Insulation Class	F	
Protection degree	IP X8	
Power rating	[kW]	1.1 ÷ 2.25
	[HP]	1.5 ÷ 3
Frequency [Hz]	50	
Voltage [V]	230 ±10%	400 ±10%
Capacitor	Control box	-
Over load protection	Built in	Provided by the user
Float switch	Standard	-
Float switch cable	material	H07RN-F
	size	3G1
Power cable	length [m]	20
	material	H07RN-F
Dimensions of cable	Cable Gland	

## SECTIONAL VIEW

### 50DEMINY

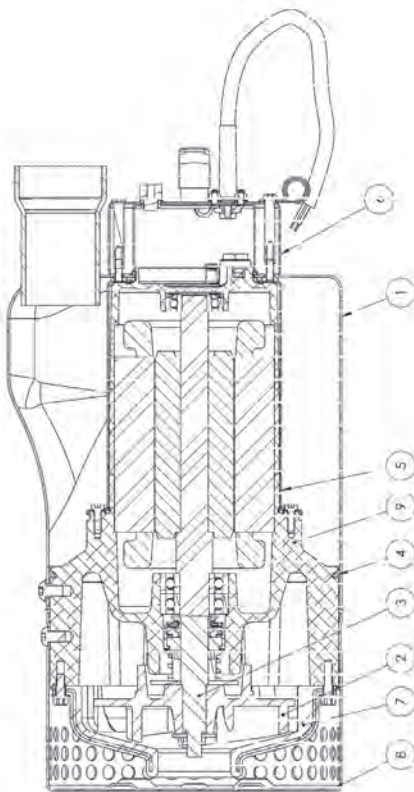

### 80DEMINY

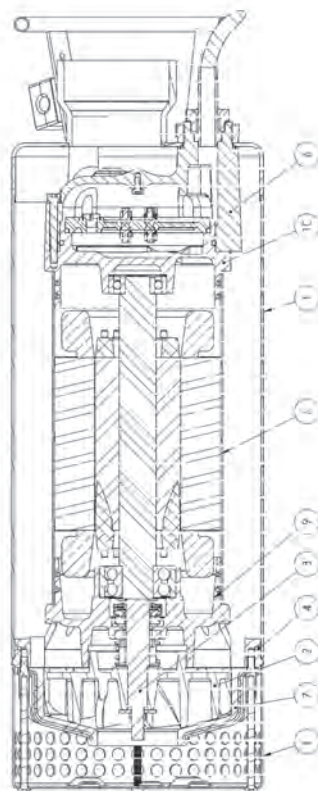

### 100DEMINY

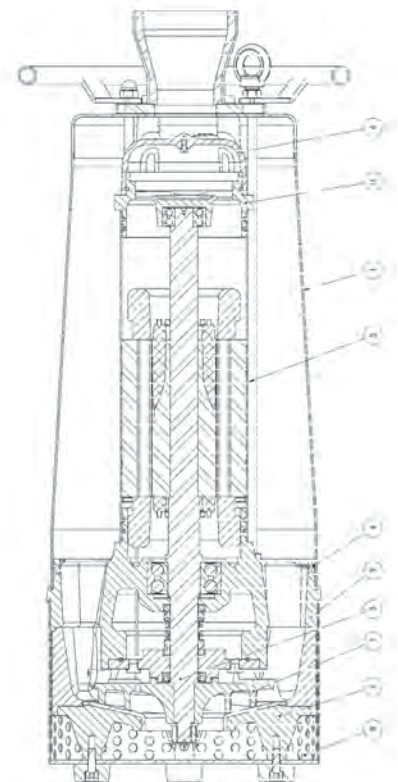

N°	PART NAME	MATERIAL	Q.TY
1	External housing	AISI 304	1
2	Impeller	AISI 304 Micro fusion	1
3	Shaft pump side	AISI 316	1
4	O-ring	NBR	1
5	Motor cover	AISI 304	1
6	Cover	AISI 304	1
7	Diffuser	HNBR with steel core	1
8	Suction base	AISI 304	1
9	Lower flange	Aluminium	1

N°	PART NAME	MATERIAL	Q.TY
1	External housing	AISI 304	1
2	Impeller	AISI 304 Micro fusion	1
3	Shaft pump side	AISI 316	1
4	o-ring	NBR	1
5	Motor cover	AISI 304	1
6	Cover	G20	1
7	Diffuser	HNBR with steel core	1
8	Suction base	AISI 304	1
9	Lower flange	Aluminium	1
10	Upper flange	G20	1

N°	PART NAME	MATERIAL	Q.TY
1	External housing	AISI 304	1
2	Impeller	GJS400 with treatment	1
3	Shaft pump side	AISI 316	1
4	o-ring	NBR	1
5	Motor cover	AISI 304	1
6	Cover	G20	1
7	Diffuser	G20 with HNBR	1
8	Suction base	AISI 304	1
9	Lower flange	G25	1
10	Upper flange	G20	1

## DIMENSION

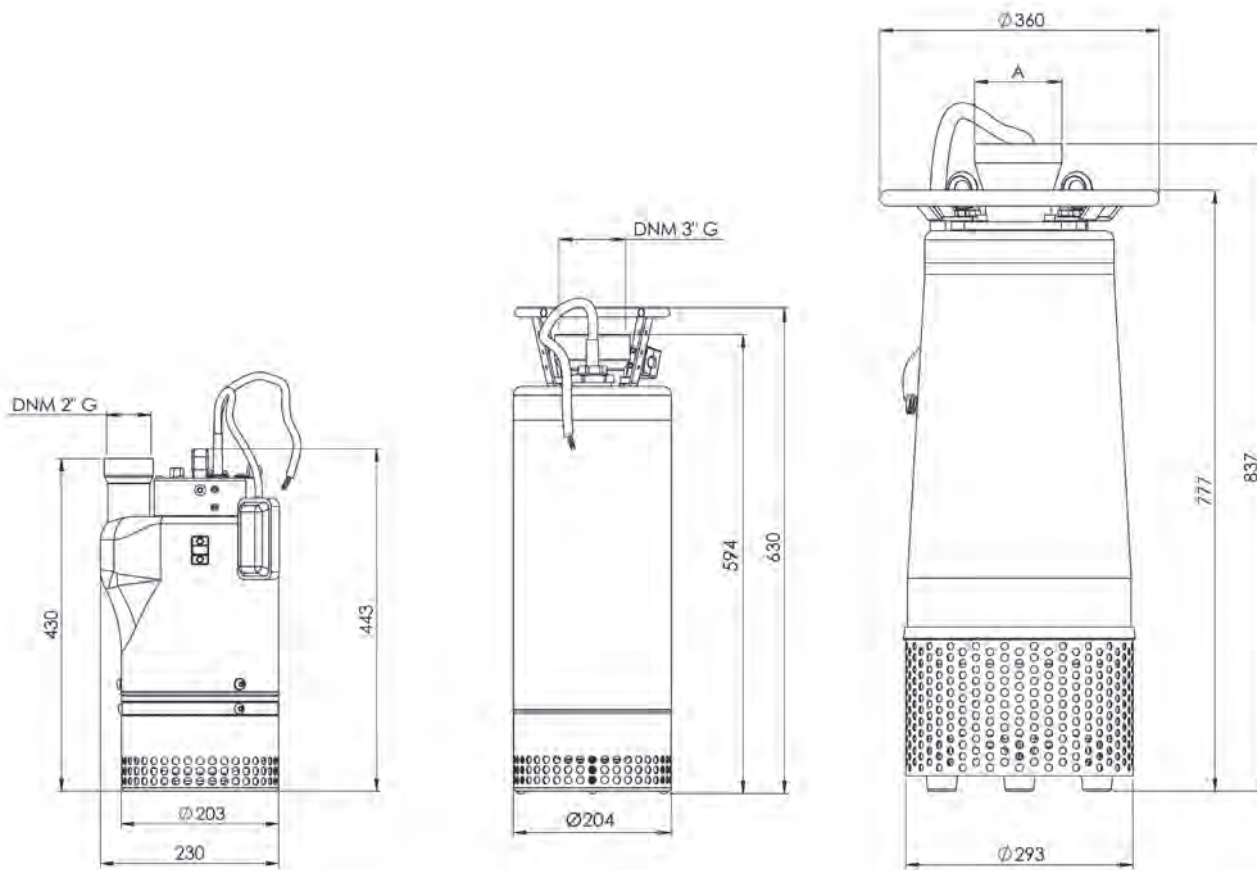

50DEMINY			
Pump type	H [mm]	B [mm]	Weight [kgf]
50DEMINY51,1M	443	230	21
50DEMINY51,1T	443	230	21
50DEMINY51,5M	443	230	21,5

80DEMINY			
Pump type	H [mm]	B [mm]	Weight [kgf]
80DEMINY52,25M	630	Ø204	36
80DEMINY52,25T	630	Ø204	36,5
80DEMINY53T	630	Ø204	37,5
80DEMINY54,5T	630	Ø204	40,5

100DEMINY				
Pump type	H [mm]	A [DNM]	B [mm]	Weight [kgf]
100DEMINY55,5T	837	4"	360	100,5
100DEMINY57,5HT	837	4"	360	101
100DEMINY57,5T	837	4"	360	101,5
100DEMINY59,5T	837	4"	360	104,5
100DEMINY512,5T	837	4"	360	105,5

\* Dimensional details are provided for reference only.  
 \* All specifications are subject to change without prior notice.



**EBARA Pumps Malaysia Sdn Bhd**  
 6, Jalan TP3, UEP Subang Jaya Industrial Park,  
 47620 Subang Jaya, Selangor, Malaysia.  
 Tel : 03-8023 6622 Fax : 03-8023 9355  
 Email : sales@ebara.com.my  
 Website : www.ebara.com.my



Approval No.0048594  
 Approval No.0049022

Authorised dealer: