



## Submersible Pumps For Dirty / Sewage Water in AISI 304 — Type DW - DW VOX

Submersible sewage pumps made of stainless steel AISI 304, with double mechanical seals ensure long life and reliability. Suitable for sewage and dirty water systems with solids. Applications include remote sewage stations for housing developments, pubs, hotels, restaurants and water displays. Options include with or without float switch. Solids handling up to 50mm.

### APPLICATIONS

- General submersible pumping
- Handling drain water and sewage for communities, hotels, restaurants, etc.
- Emptying pits and discharge into sewers
- Pumping of industrial discharges
- Draining flooded premises
- For automatic dirty water pump stations
- Supplied with 10m cable length type H07RNF
- Available with or without float switch
- Single channel impeller or vortex impeller (VOX type)
- Flanged with or without bracket (F and FZ type)

### FEATURES

- Double mechanical seal with interposed oil chamber
- Reliability
- Vortex or single channel impeller
- Easy installation
- Completely AISI 304
- Versatile with treated or flanged connection
- Customizable for various applications



PERFORMANCE CHART

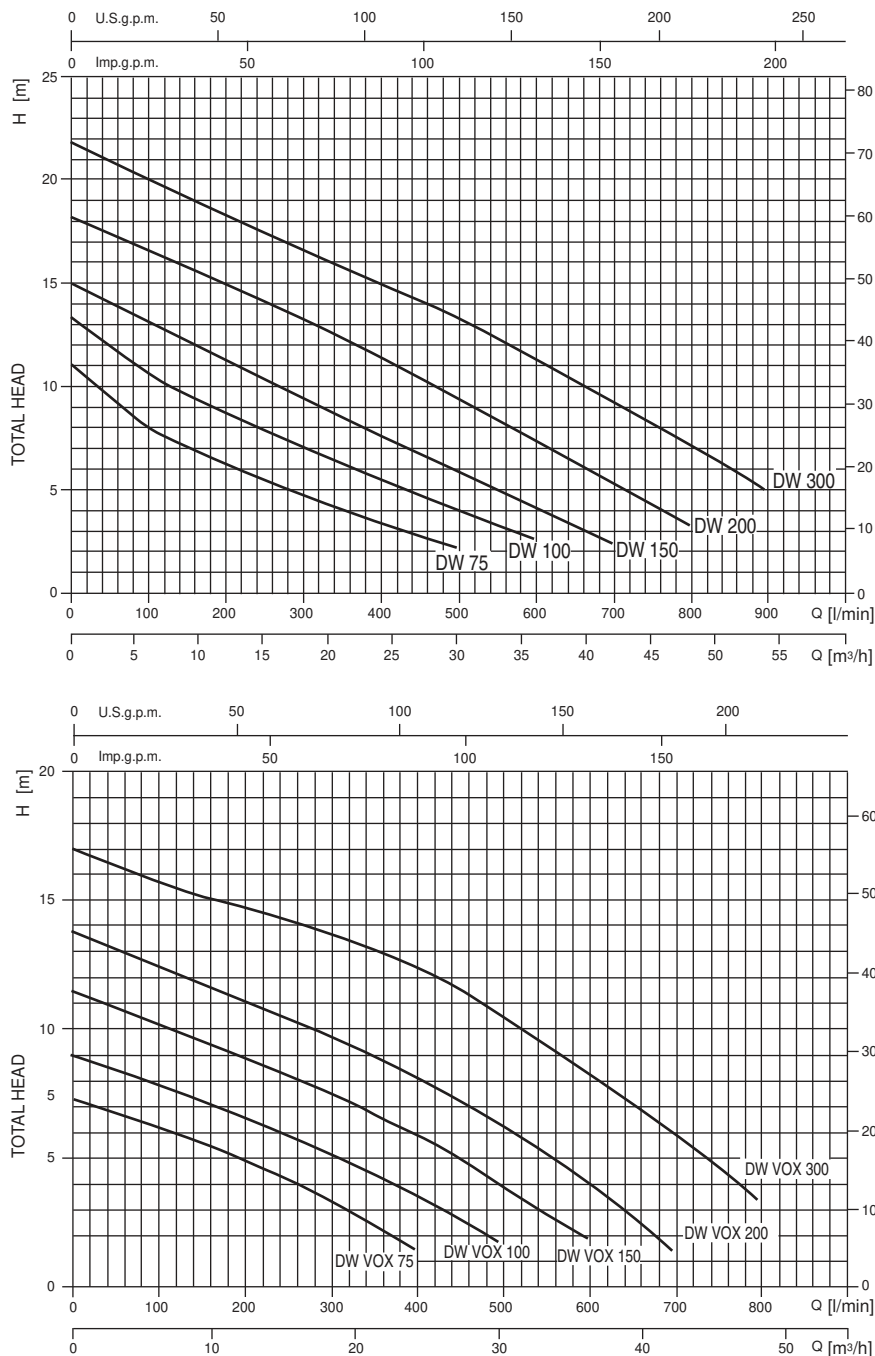

Pump type		HP	kW	Capacitor		Absorbed Current (A)		l/min m³/h	Q=Capacity								
Single-phase 230V 50Hz	Three-phase 400V 50Hz			μF	Vc	1~	3~		100	200	300	400	500	600	700	800	900
DW 75 M	DW 75	0.75	0.55	20	450	3.9	1.5	6	8	6.3	4.8	3.4	2.2	-	-	-	
DW 100 M	DW 100	1	0.75	25	450	5.9	2.1	12	10.6	8.7	7.1	5.5	4	2.6	-	-	
DW 150 M	DW 150	1.5	1.1	31.5	450	7.3	2.8	18	13.1	11.3	9.5	7.7	5.9	4.2	2.4	-	
-	DW 200	2	1.5	-	-	-	3.6	24	16.6	15	13.3	11.4	9.5	7.5	5.4	3.3	
-	DW 300	3	2.2	-	-	-	5.0	30	20	18.3	16.6	15.1	13.3	11.3	9.3	7.2	
DW VOX 75 M	DW VOX 75	0.75	0.55	20	450	3.9	1.4	6	6.3	5	3.5	1.6	-	-	-	-	
DW VOX 100 M	DW VOX 100	1	0.75	25	450	5.8	2.1	12	7.9	6.7	5.3	3.7	1.9	-	-	-	
DW VOX 150 M	DW VOX 150	1.5	1.1	31.5	450	7.3	2.8	18	10.2	9	7.6	6.1	4.1	2.1	-	-	
-	DW VOX 200	2	1.5	-	-	-	3.3	24	12.5	11.2	9.8	8.3	6.4	4.2	1.6	-	
-	DW VOX 300	3	2.2	-	-	-	4.4	30	15.7	14.7	13.9	12.6	0.7	8.4	6.1	3.6	

SECTIONAL VIEW

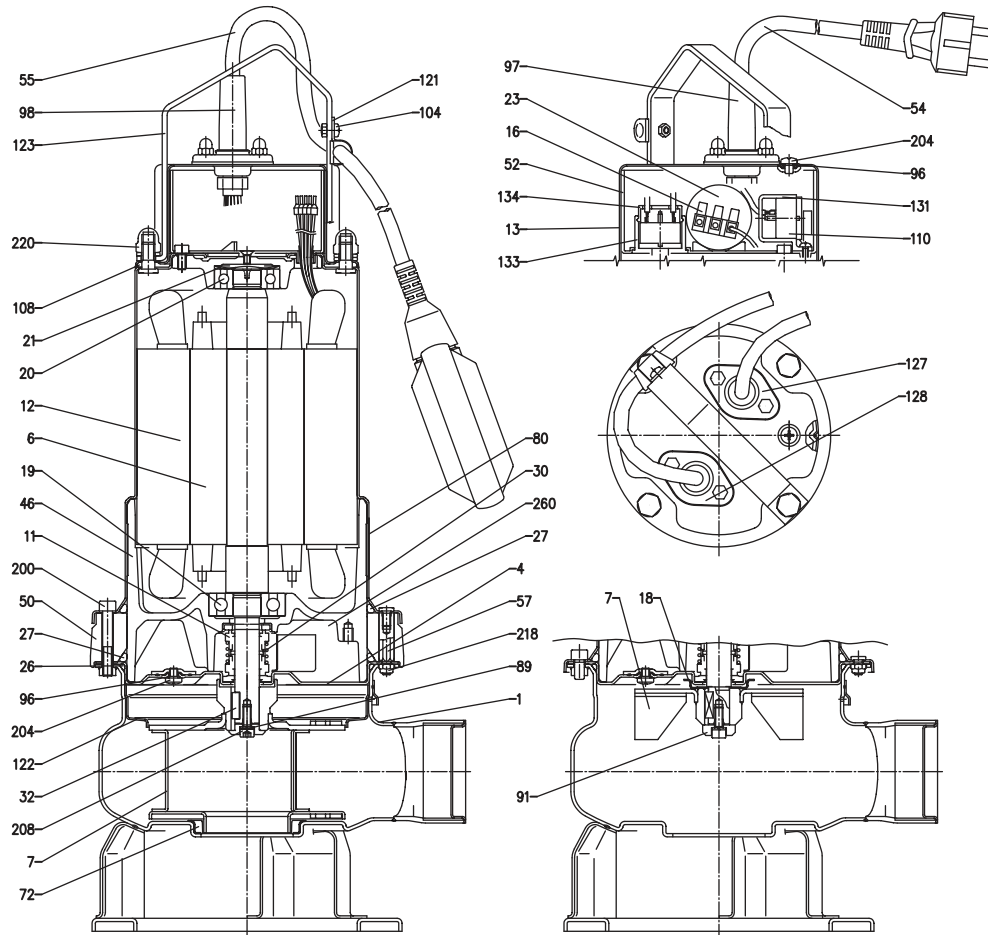

Ref.	Name	Material	Ref.	Name	Material
1	Pump body	AISI 304	57	Spacer [3]	AISI 304
4	Seal housing disc	AISI 304	72	Wear ring [5]	NBR
6	Rotor shaft	AISI 303	89	Washer	AISI 304
7	Impeller	AISI 304	91	Washer [1]	AISI 304
11	Pump side mechanical seal	SiC/SiC/NBR	96	O-Ring	NBR
11	Motor side mechanical seal	Carbon/Ceramic/NBR	97	Power supply cable	NBR
12	Pump body	-	98	Cable gland for float [4]	NBR
13	Motor cover	AISI 304	104	Float cable stay [4]	NBR
16	Terminal box	-	108	Motor cover gasket	NBR
18	Seal protection [1]	AISI 304	110	Motorprotector [2]	-
19	Pump side bearing	-	121	Supp. for float [4]	AISI 304
20	Motor side bearing	-	122	Impeller prot. ring [6]	AISI 304
21	Adjusting ring	Steel C70	123	Handle	AISI 304
23	Capacitor [2]	-	127	Cable connector	AISI 304
26	O-Ring	NBR	128	Connector [4]	AISI 304
27	O-Ring	NBR	131	Motorprotector support [7]	PA66 reinforced with fibreglass
27	O-Ring [3]	NBR	133	Motorprotector probe support [7]	Aluminium
30	Mechanical seal spacer	Brass	134	Motorprotector probe support lid [7]	PA6
32	Key	AISI 304	200	Screw	Steel A2 UNI 7323
46	Bearing support	G20	204	Screw	Steel A2 UNI 7323
50	Spacer [3]	G20	208	Screw	Steel A2 UNI 7323
52	Cap. box	PA66 reinforced with fibreglass	218	Nut	Steel A2 UNI 7323
54	Power supply cable	-	220	Nut	Steel A2 UNI 7323
55	Float [4]	-	260	Lubr. liquid	Oil

[1] Except DW-DW VOX 300

[3] Only for DW-DW VOX 300

[5] For DW only

[7] For DW150 single phase only

[2] For single phase only

[4] For single phase without float only

[6] Except DW VOX 150,200 and 30

**DIMENSION**

**DW  
DW VOX**

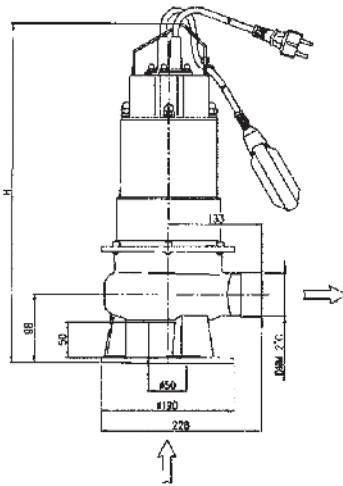

**DWF  
DW VOX F**

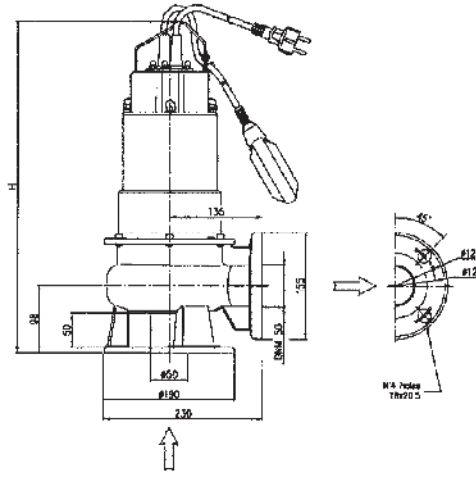

**DW FZ  
DW VOX FZ**

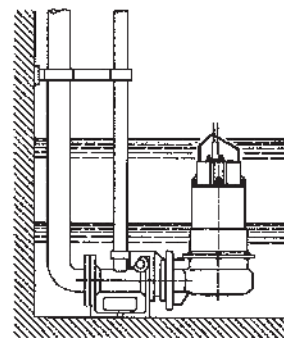

**DW  
DW VOX**

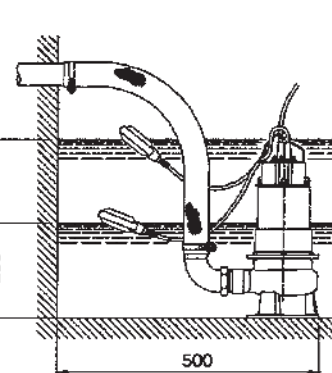

Pump	Dimensions (mm) H	Weight kg
DW 75	485	16
DW 100	515	18
DW 150	515	20
DW 200	515	20
DW 300	545	26

Pump	Dimensions (mm) H	Weight kg
DW VOX 75	485	16
DW VOX 100	515	18
DW VOX 150	515	20
DW VOX 200	515	20
DW VOX 300	545	26

\* Dimensional details are provided for reference only.  
\* All specifications are subject to change without prior notice.



**EBARA Pumps Malaysia Sdn Bhd**  
6, Jalan TP3, UEP Subang Jaya Industrial Park,  
47620 Subang Jaya, Selangor, Malaysia.  
Tel : 03-8023 6622 Fax : 03-8023 9355  
Email : sales@ebara.com.my  
Website : www.ebara.com.my



Certificate No. KLR 05000980  
Certificate No. KI R 6027851

Authorised dealer: