



Submersible Dewatering Pump

High Head Series _____ Type EU

Submersible pumps with only a single impeller except (150EU5150) carry out dewatering job up to unbelievable higher locations. Simple structure of these models ensures easy maintenance at your heavy-duty worksites.

APPLICATIONS

- Drainage out of sumps, pits, quarries, minings, cellars
- Tunnels, Caisson dewaterings, reclaiming operations, power station constructions
- Waste, storm or emergency water removal, dams, harbour projects
- Contractors & rental companies, etc

FEATURES

- **Motor Protector**

Incorporating Miniature Thermal Protector (MTP) and Infiltrative Water Detector (WD) in the pump body protect the motor from thermal and mechanical troubles. Both in combination with external pump operating panel equipped with Electro Magnetic Contactor (MC), Infiltrative Water Detector Relay Set (WD-X) and Thermal Relay (THR), the pump assures perfect and safety-minded motor protection. In case water infiltrates the motor housing or the temperature in the motor coil rises to a set maximum, the WD fitted immediately beneath the motor compartment or the MTP activates the MC by way of WD-X or THR in order to cut off the electric supply to the motor. 100EU522 is not with MTP nor WD. This models shall be provided with an external pump operating panel equipped with MC for the protection of the motor upon request.

- **Motor**

The motors are well designed to demonstrate higher motor efficiency and torque. The stators conform to class B insulation rating, ensure high heat resistance.



FEATURES

- Shaft Seal**

Double mechanical seals are cooled and lubricated in the oil bath. Together with the good effect of design of pressure relief furnished just beneath the motor compartment, guarantee reliable sealing effect and steady effect & service at heavy-duty sites for a long period of time.

- Impeller & Casing**

Close impeller made of High Chrome Alloy in heavy gauge body gives high efficiency in pumping performance in combination with assorted casing as well as providing admirable resistance in the water containing abrasive solid particles.

- Grease Replenisher**

Grease replenishing attachment is furnished with the models in this series with more than 100HP motor output to simplify their grease maintenance of bearings.

NOTE : In the case of stationary operation, water level regulating equipment is available at extra cost upon your request. Motors bigger than 50HP are star-delta starting. Other specifications shall be considerable upon requests.

SPECIFICATIONS

- Discharge Dia. : 100 - 250mm
- Total Head : 33 - 200m
- Capacity : 1.0 - 10m³/min
- Motor Output : 22 - 185kW

PERFORMANCE CURVE

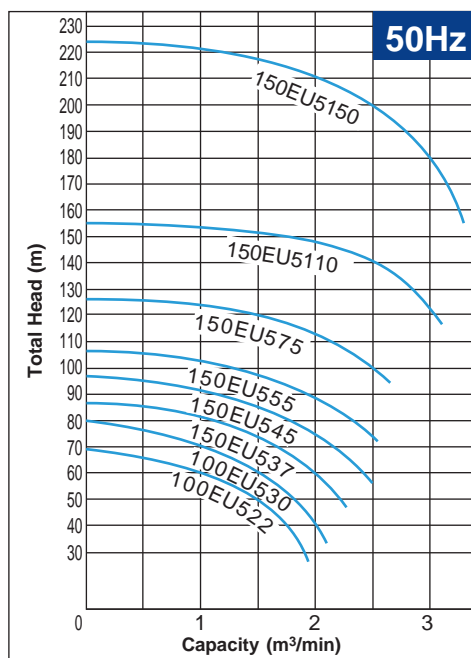

Model	Nominal diameter (mm)	Output (kW)	Ph/Hz/V	Total Head (m)	Capacity (m ³ /min)	Max. Head (m)	Outer dimension (mm)		Weight (kg)
							Max. diameter	Height	
50Hz									
100EU522	100	22	3Ph/50Hz/ 380-415V	60	1.0	68	455	970	280
100EU530	100	30		70	1.0	78	420	1130	380
150EU537	150	37		80	1.0	87	542	1385	485
150EU545	150	45		90	1.0	96	542	1315	485
150EU555	150	55		90	2.0	105	542	1385	545
150EU575	150	75		120	1.5	125	570	1550	980
150EU5110	150	110		140	2.5	155	565	1550	1080
150EU5150	150	150		200	2.5	225	550	1760	1250

PERFORMANCE CURVE

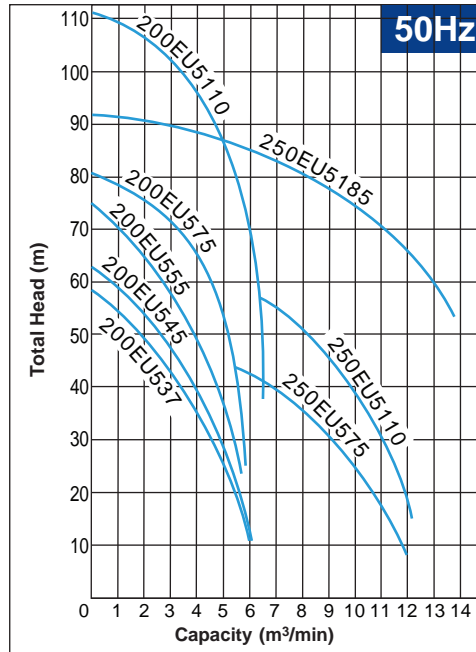

Model	Nominal diameter (mm)	Output (kW)	Ph/Hz/V	Total Head (m)	Capacity (m³/min)	Max. Head (m)	Outer dimension (mm)		Weight (kg)
							Max. diameter	Height	
200EU537	200	37	3Ph/50Hz/ 380-415V	35	4.0	58	542	1385	510
200EU545	200	45		40	4.0	63	542	1315	510
200EU555	200	55		50	4.0	75	542	1385	560
200EU575	200	75		60	4.5	80	570	1550	980
200EU5110	200	110		90	4.5	110	570	1550	1080
250EU575	250	75		33	8.4	53	680	1585	980
250EU5110	250	110		50	8.4	67	565	1585	1000
250EU5185	250	185		74	10.0	92	735	1900	1450

SECTIONAL VIEW

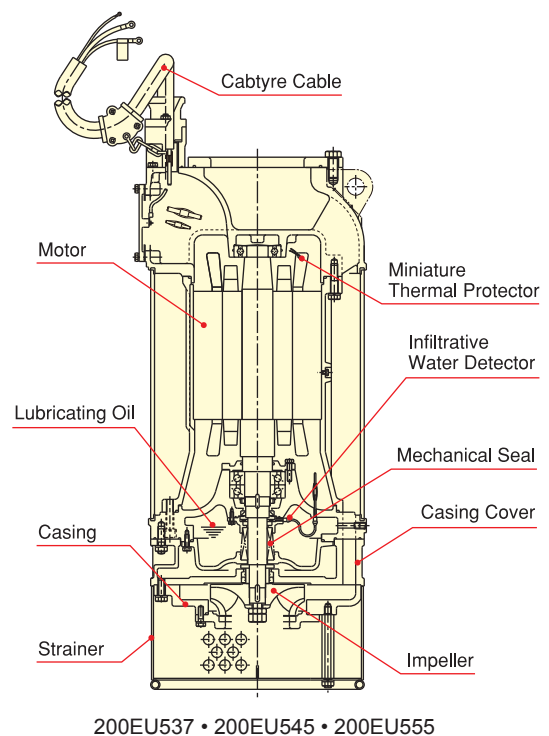
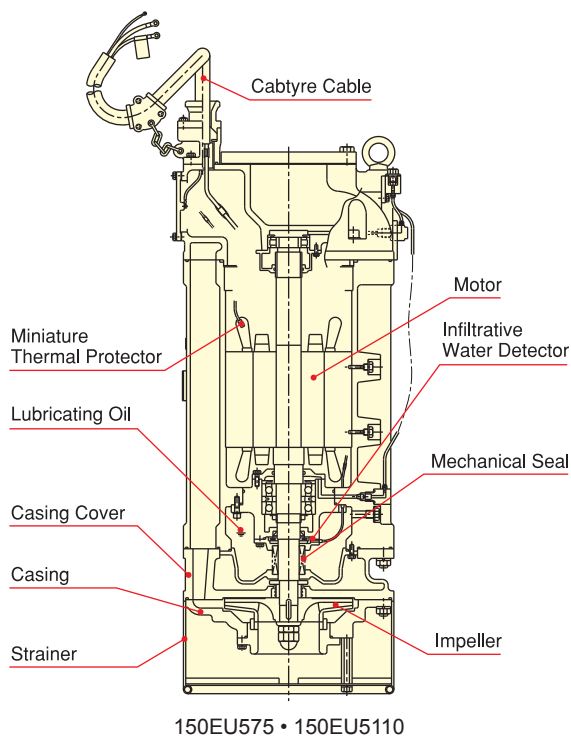

DIMENSION

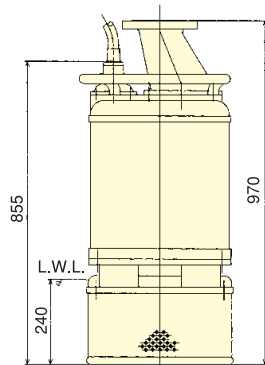
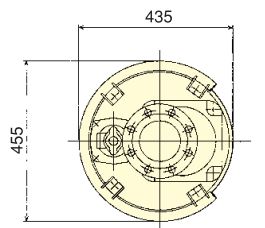

100EU522

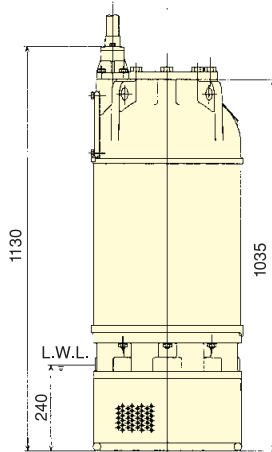
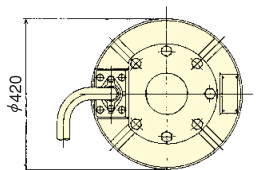

100EU530

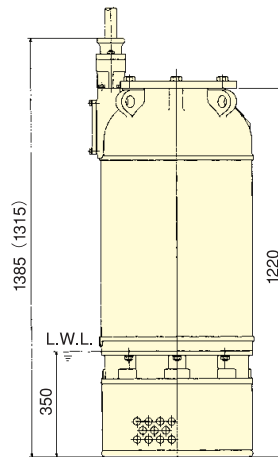
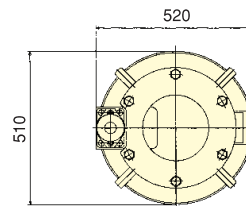

150EU537 • 150EU545 • 150EU555
200EU537 • 200EU545 • 200EU555

Dimension in () refers to 150EU545 and 200EU545

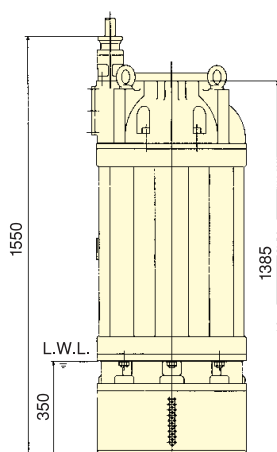
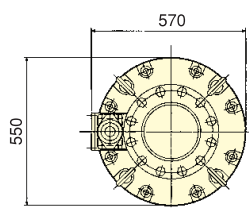

150EU575 • 150EU5110
200EU575 • 200EU5110

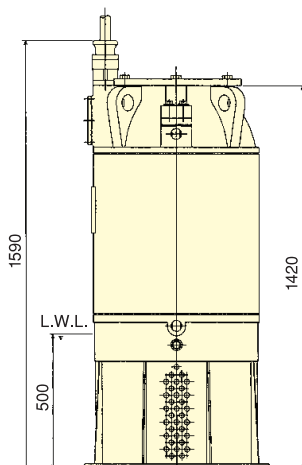
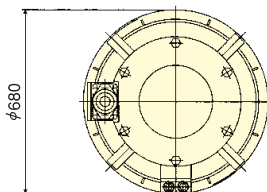

250EU575 • 250EU5110

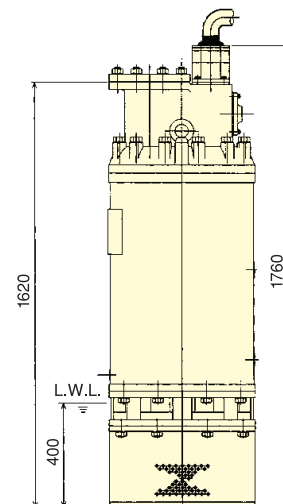
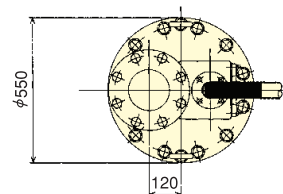

150EU5150

* Dimensional details are provided for reference only.
* All specifications are subject to change without prior notice.



EBARA Pumps Malaysia Sdn Bhd
6, Jalan TP3, UEP Subang Jaya Industrial Park,
47620 Subang Jaya, Selangor, Malaysia.
Tel : 03-8023 6622 Fax : 03-8023 9355
Email : sales@ebara.com.my
Website : www.ebara.com.my



Certificate No. KLR 0500080
Certificate No. KLR 6027851

Authorised dealer: